

拼装步骤

Step 01

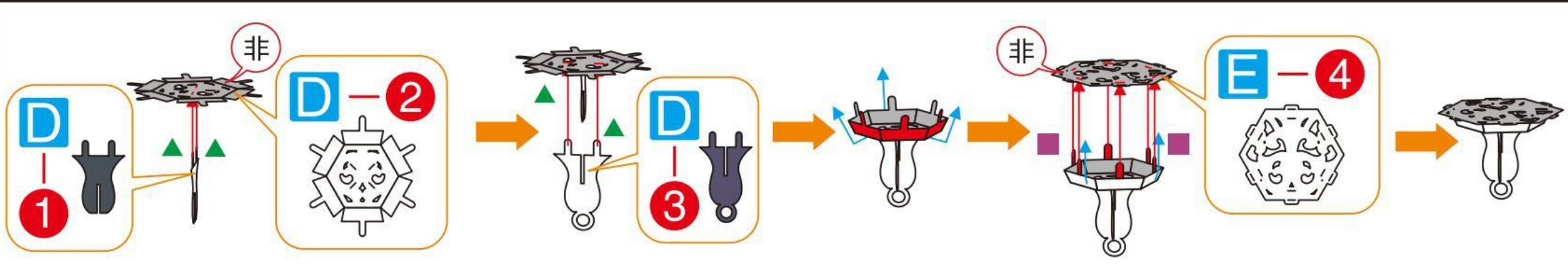

Step 02

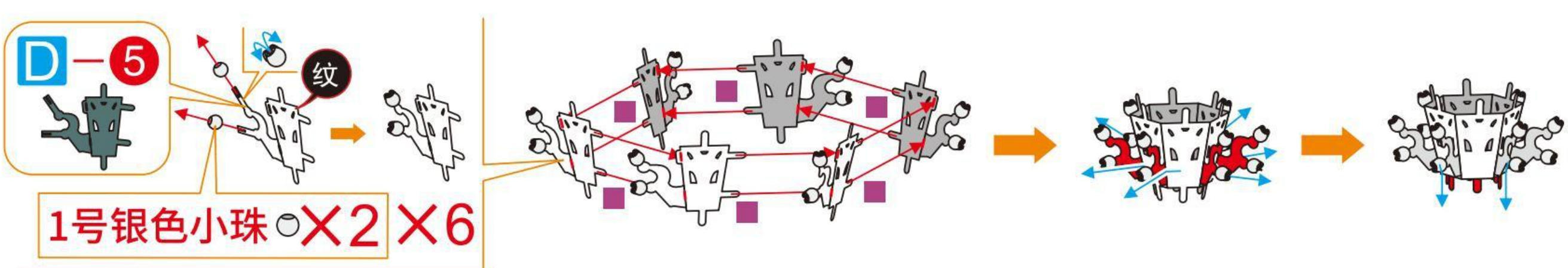

Step 03

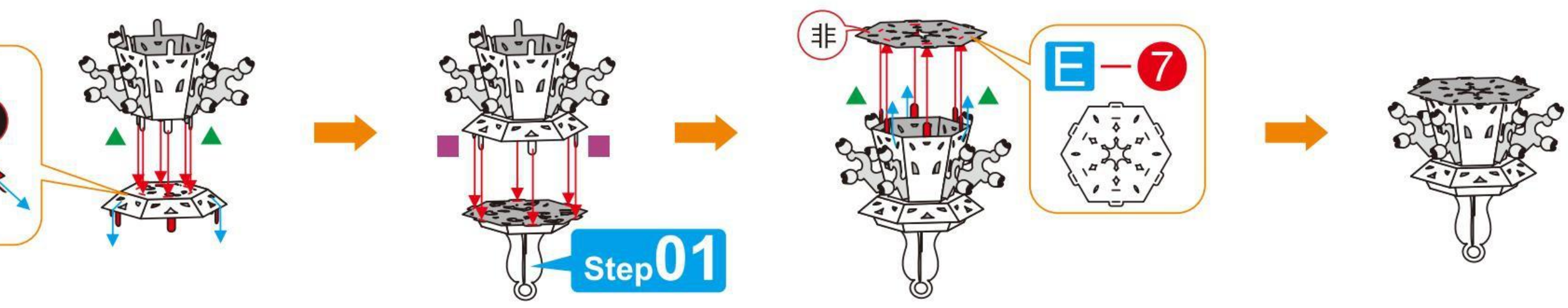

Step 04



Step 05

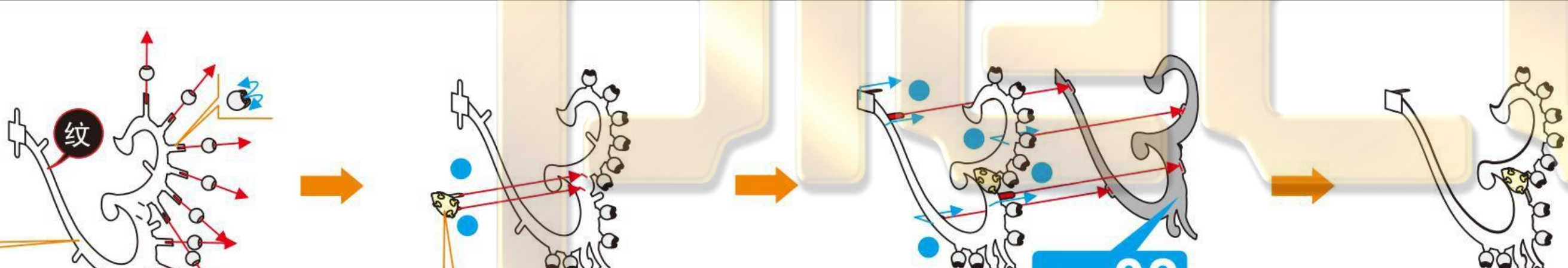

Step 06



Step 07

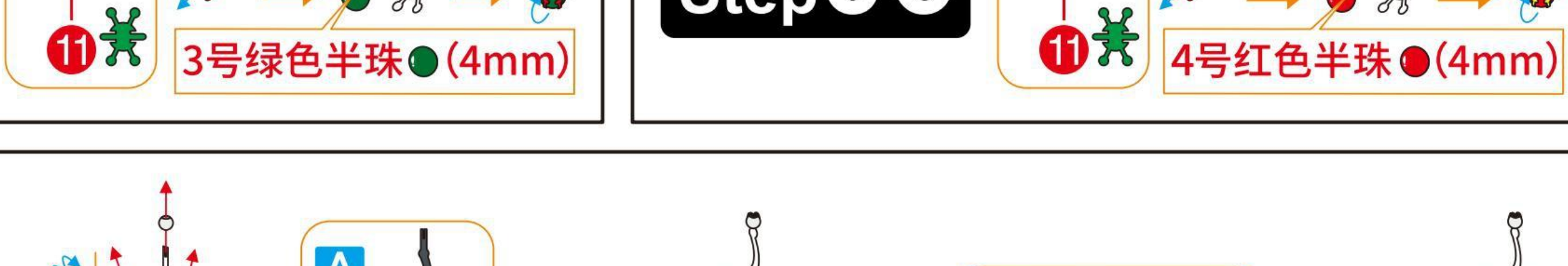

Step 08

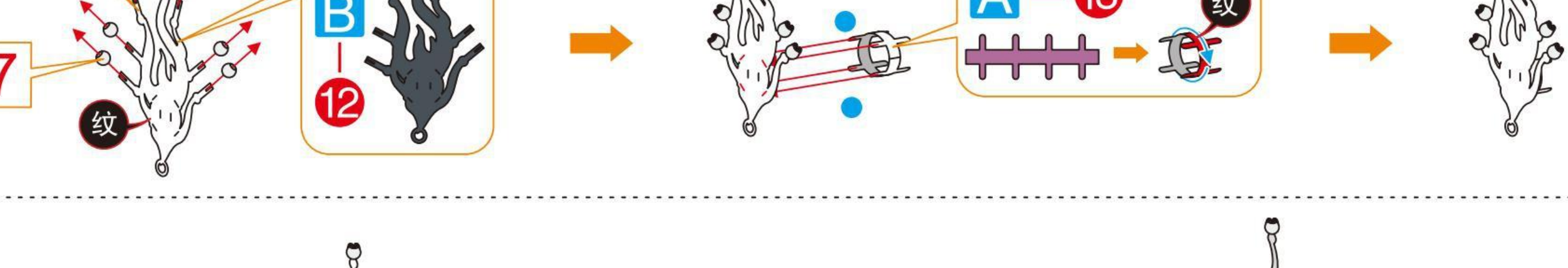

Step 08

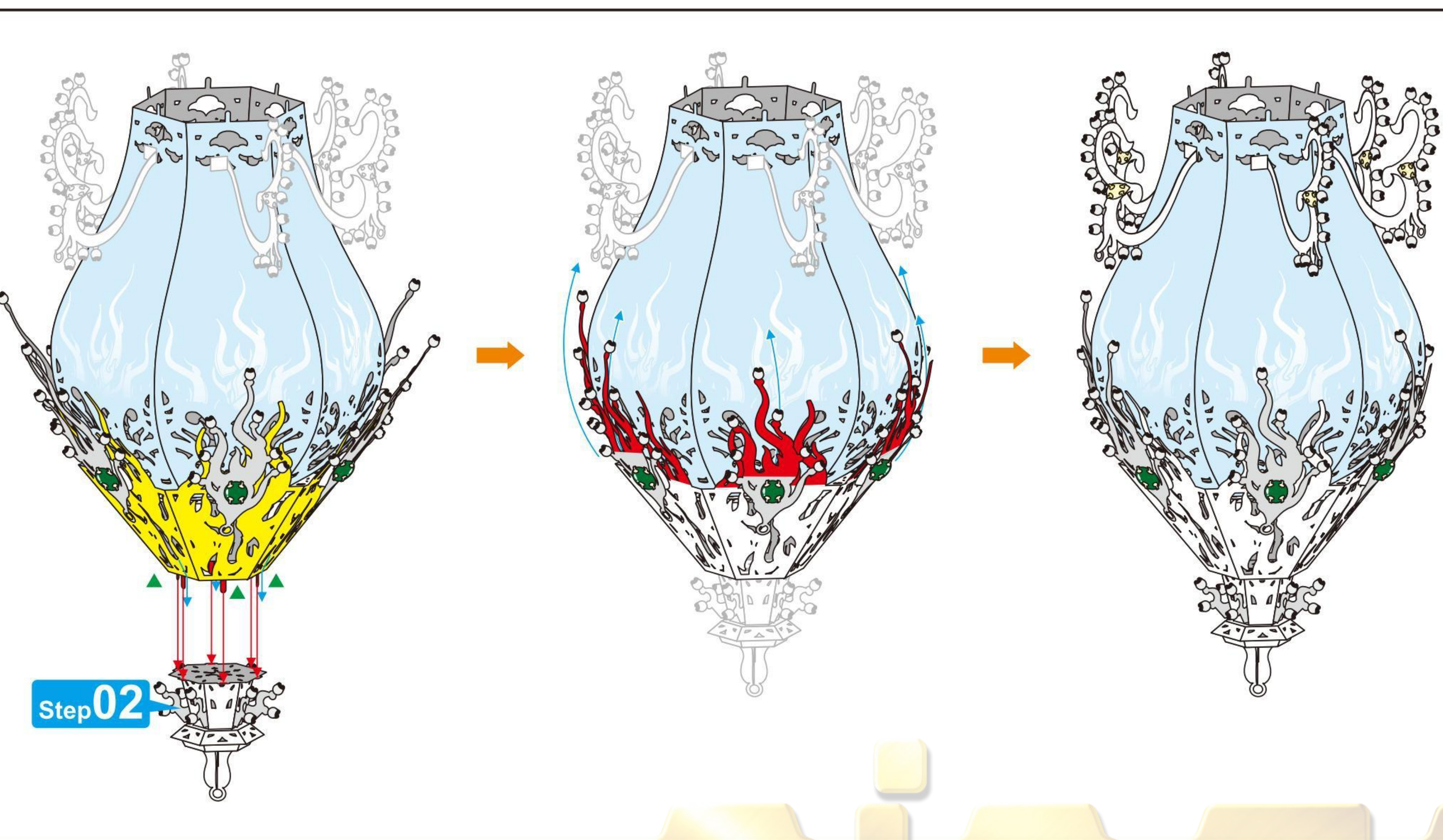
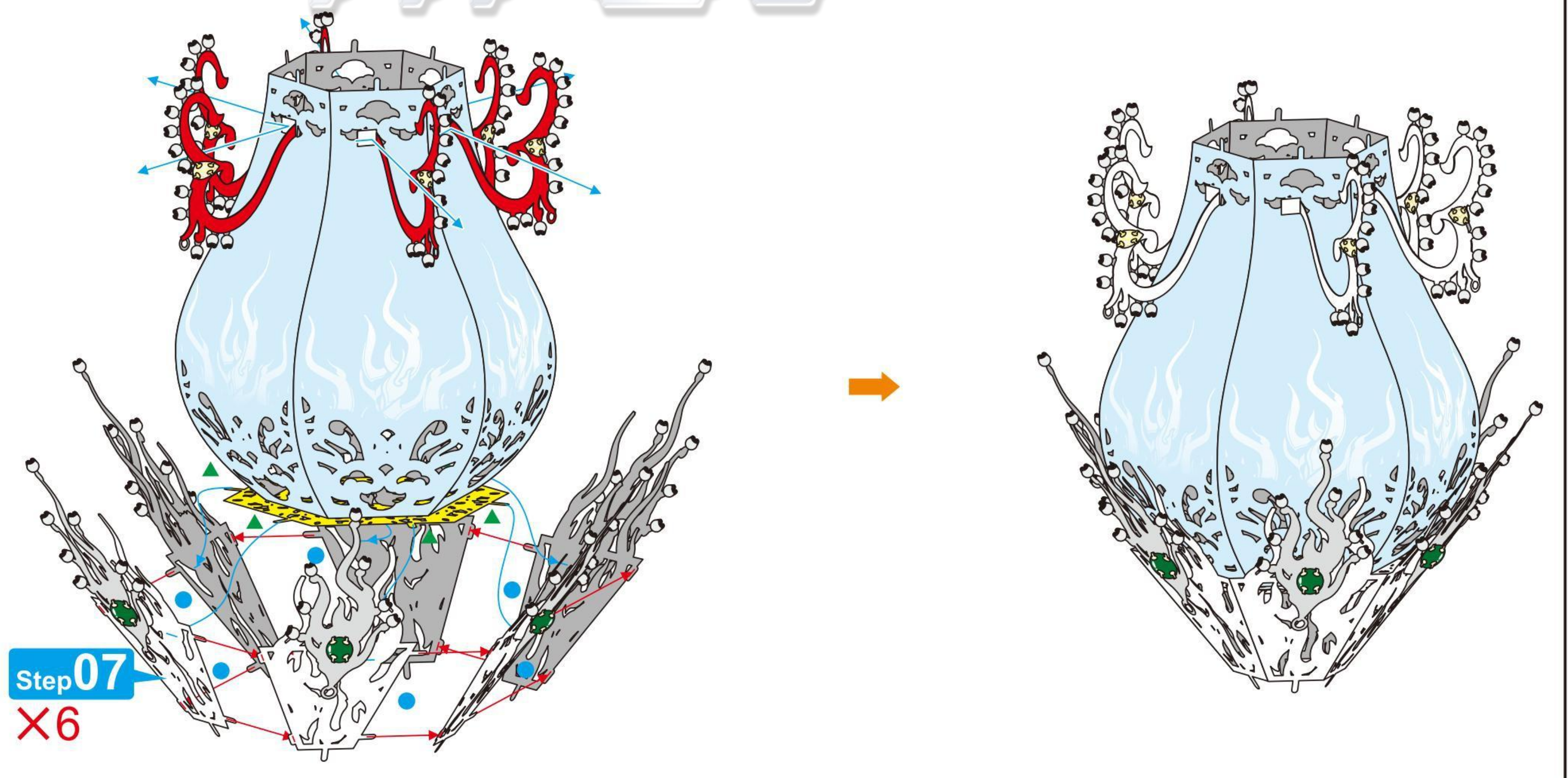
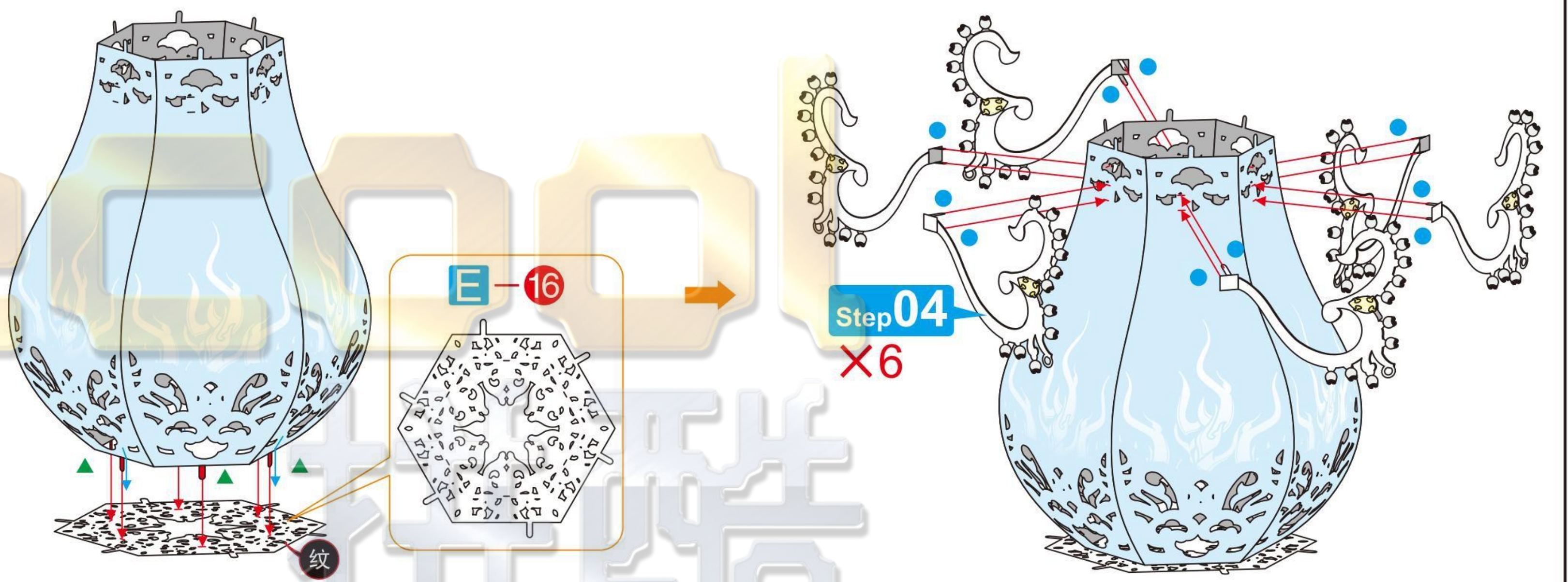
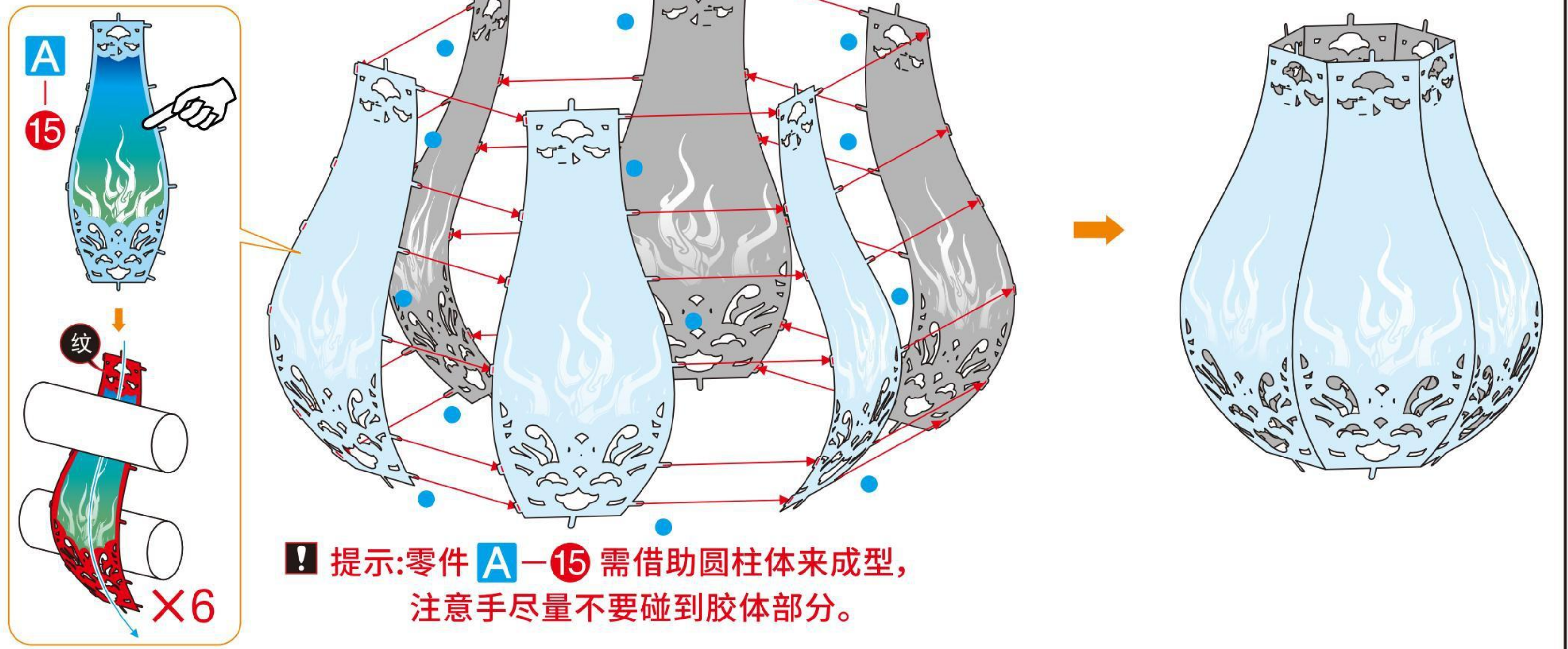

Step 09



Step 10



Step 11

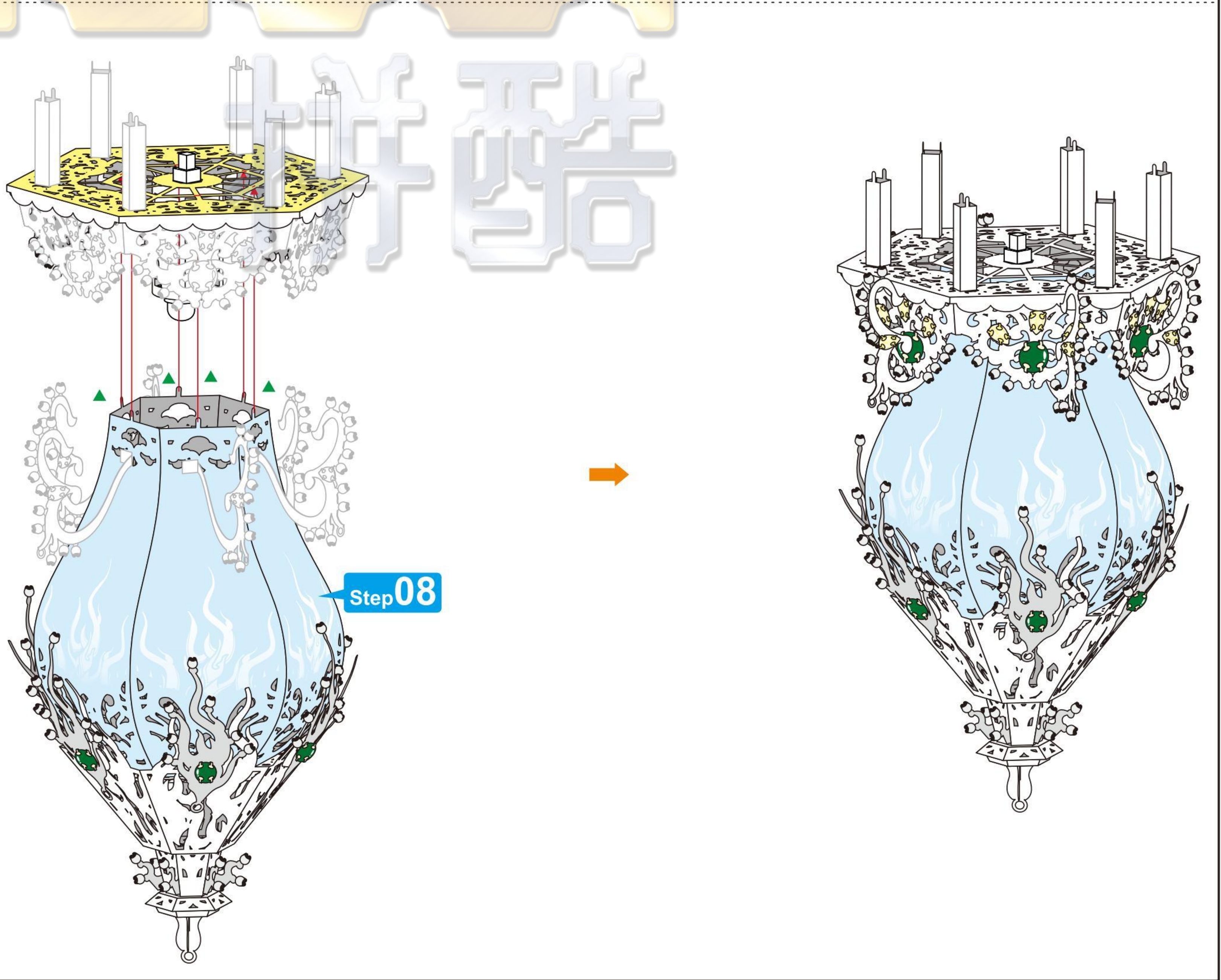
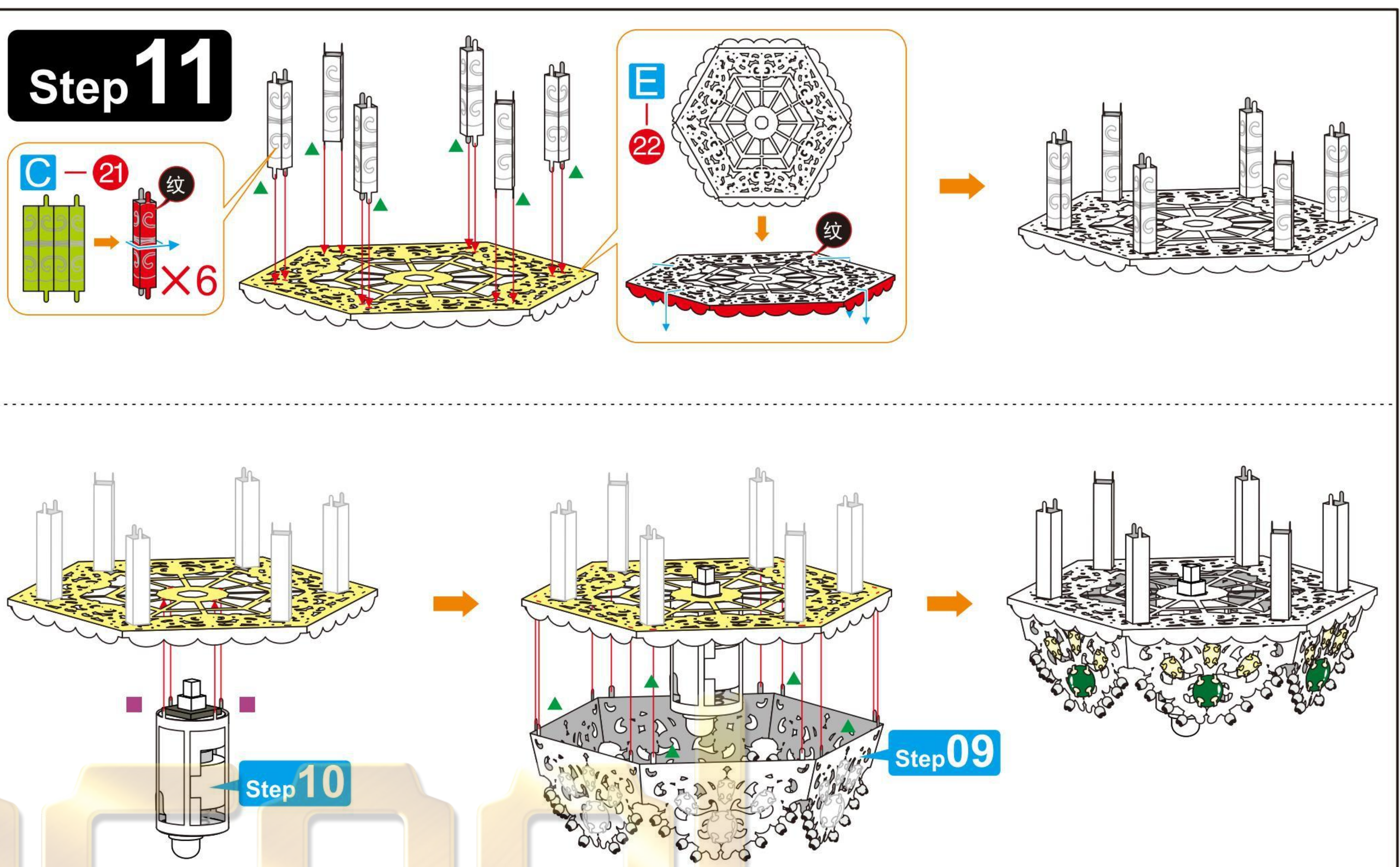
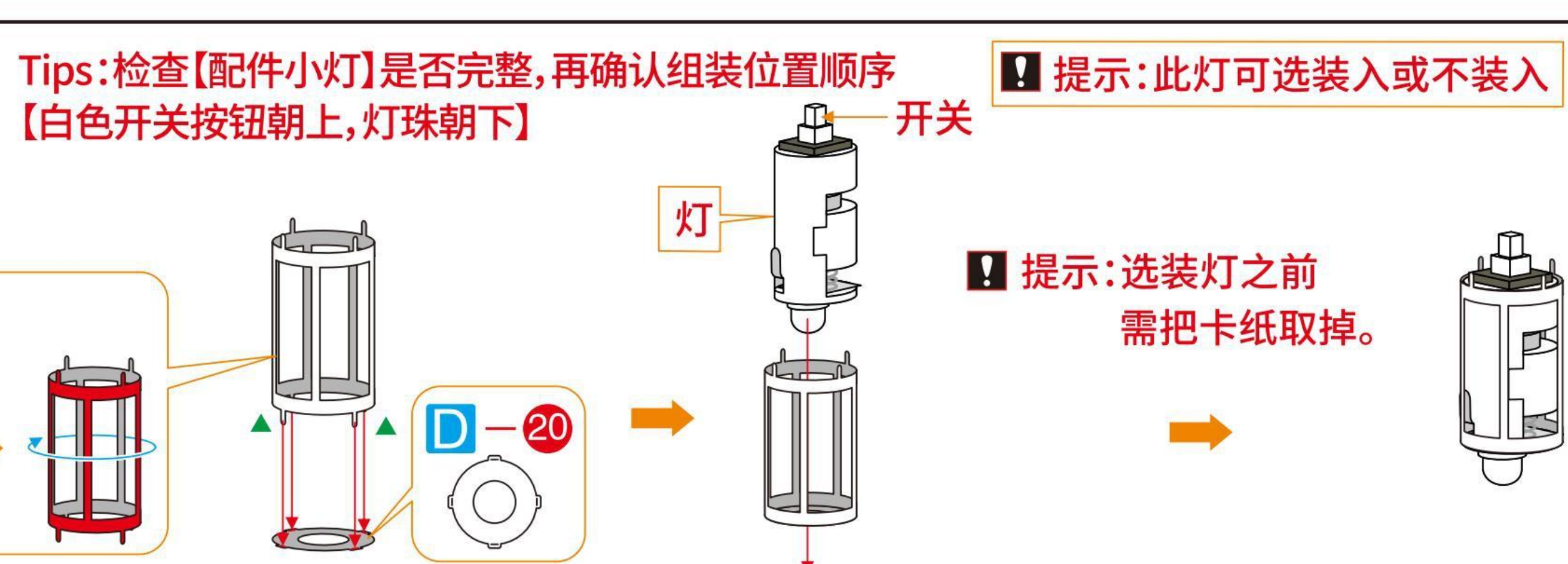

! 电池装换方法: 打开电池仓盖-识别电池摆放位置(平底端贴近弹簧)-放入电池(纽扣电池类型为LR41, 额定电压为1.5V, 数量x3)-关闭电池仓盖。

Step 12

1号银色小珠 $\times 8$

A-23

C-18

6号红色大半珠 (5mm) $\times 6$

此处先不扣

E-24

先扣红色线

Step 13

B-25

7号绿色水滴大半珠 $\times 6$

Step 14

BDE-8 $\times 2$

2号水滴半珠

E-26

Step 13

$\times 6$

Step 15

8号金色小珠 $\times 11$

B-27

Step 05

$\times 6$

Step 16

8号金色小珠 $\times 11$

A-28

Step 05

$\times 6$

Step 17

1号银色小珠 $\times 10$

BC-29

BDE-8

2号水滴半珠

Step 15

翻转

$\times 6$

Step 18

1号银色小珠 $\times 21$

D-30

BDE-8

2号水滴半珠

Step 17

Step 16

$\times 6$

Step 19

Step 12

Step 18 $\times 6$

Step 14

Step 11

Step 20

E-32

E-33

E-34

E-35

D-36

E-37

D-38

E-39

Step 21

Step 20

E-40

1号银色小珠 $\times 3$

Step 06

$\times 6$

Step 22

Step 05

D-41

$\times 6$

E-42

Step 23

E-43

Step 22

$\times 6$ Step 05

Step 21

注意组装方向

E-44

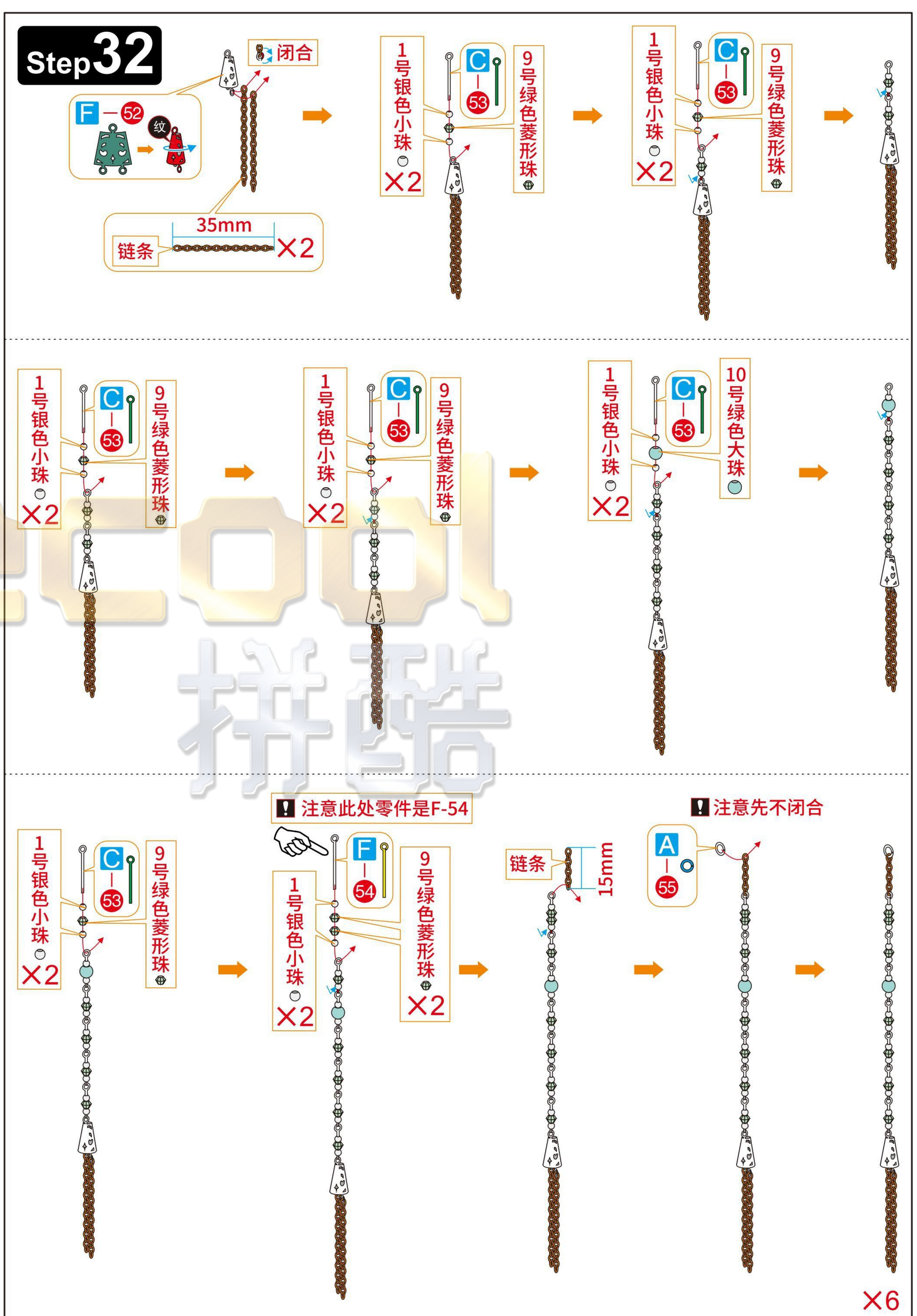
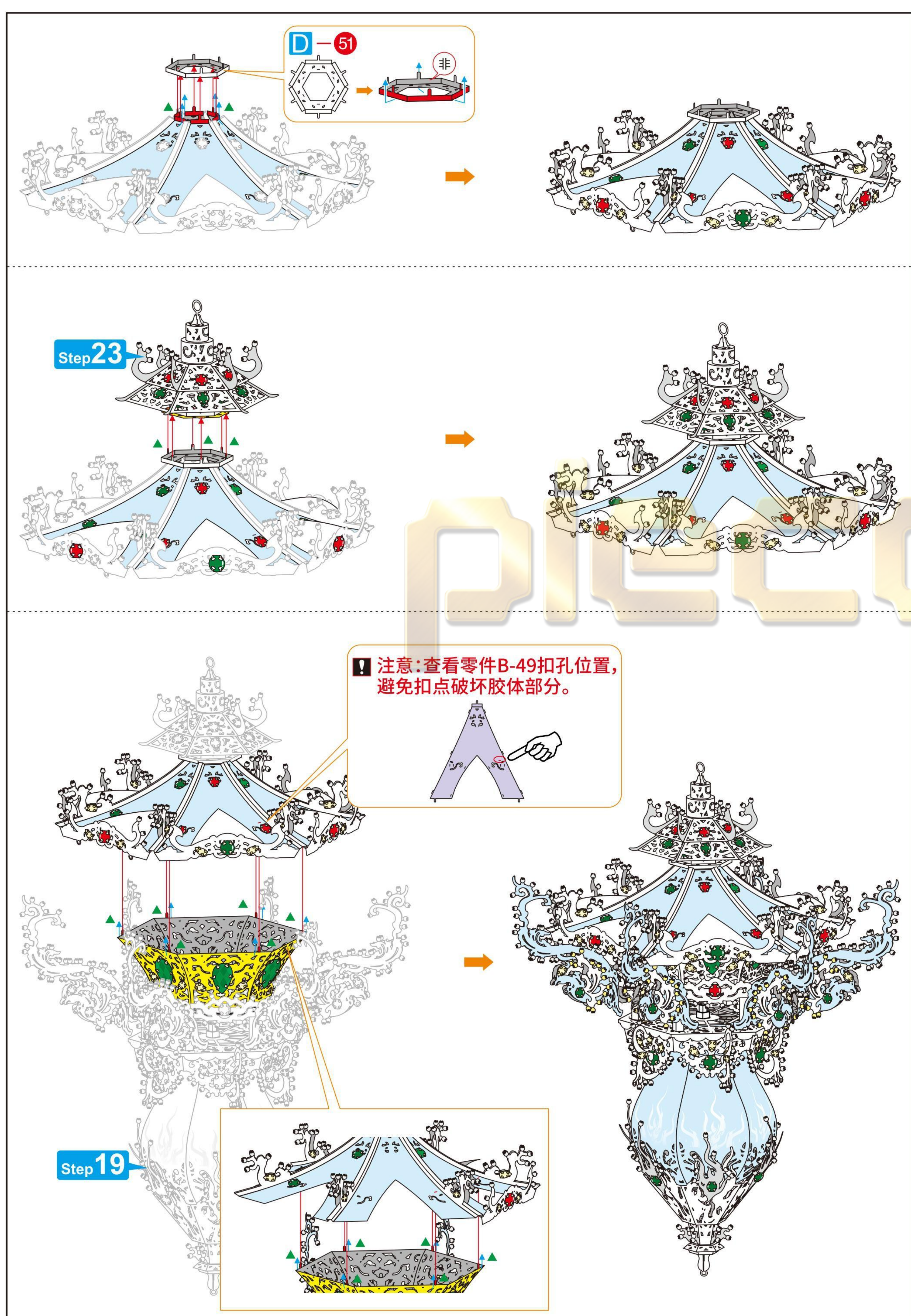
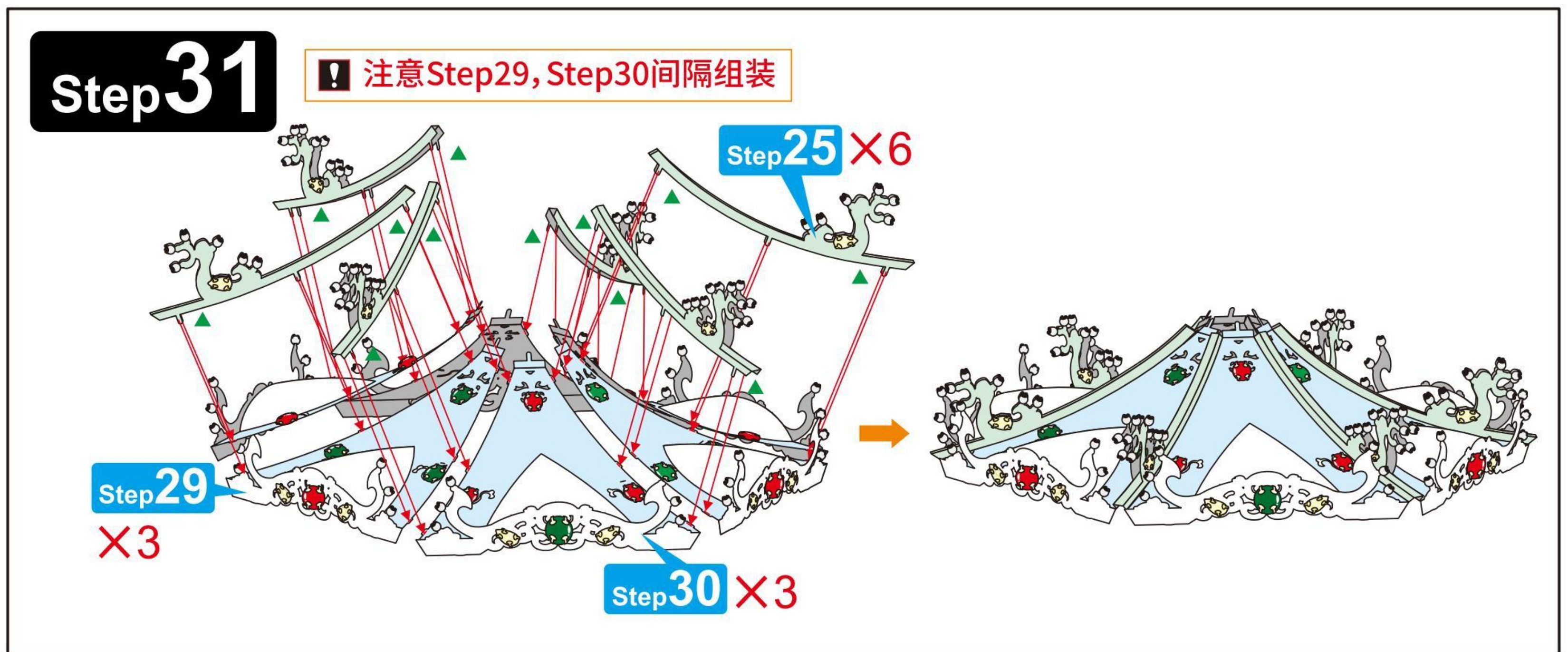
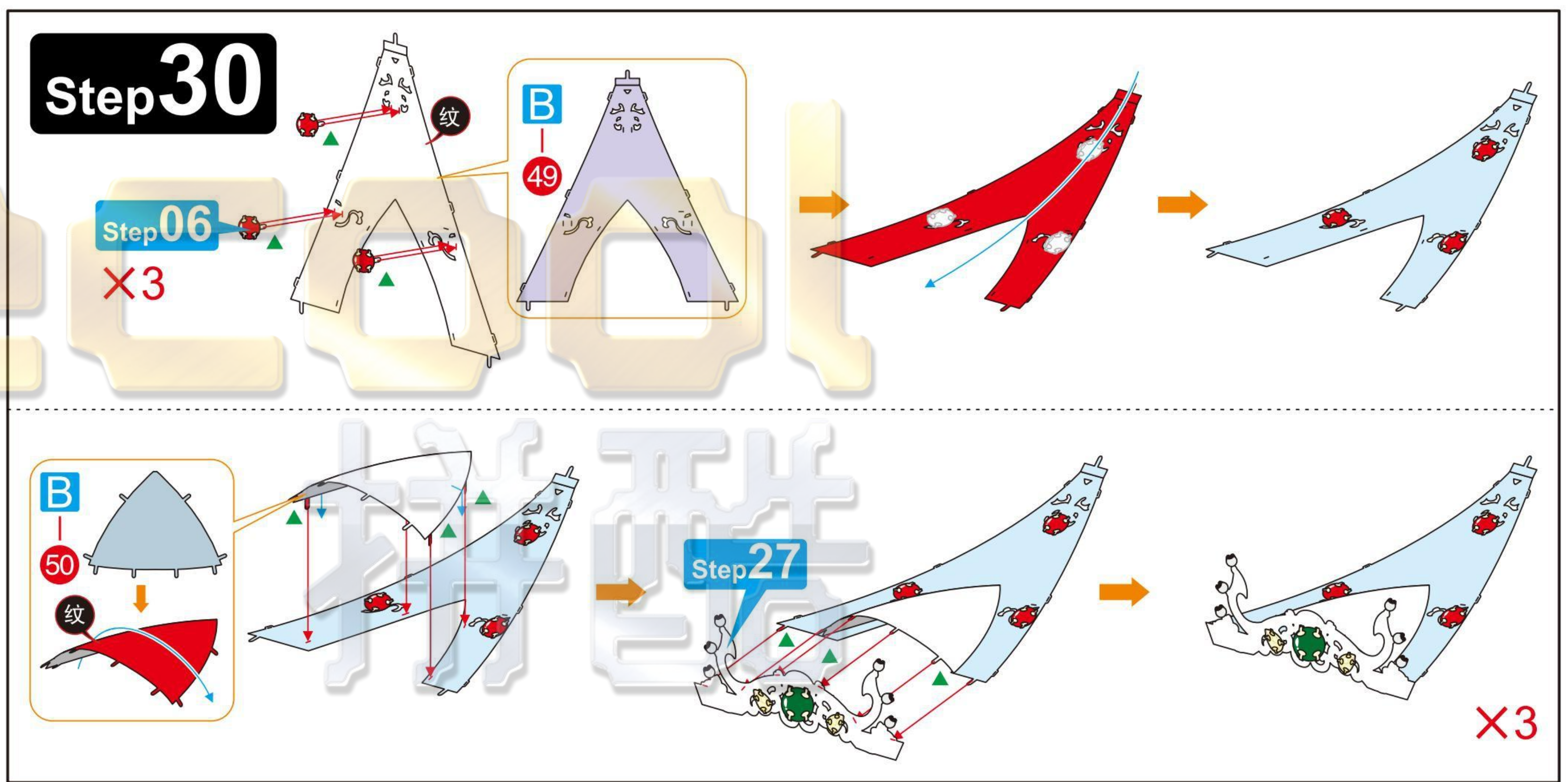
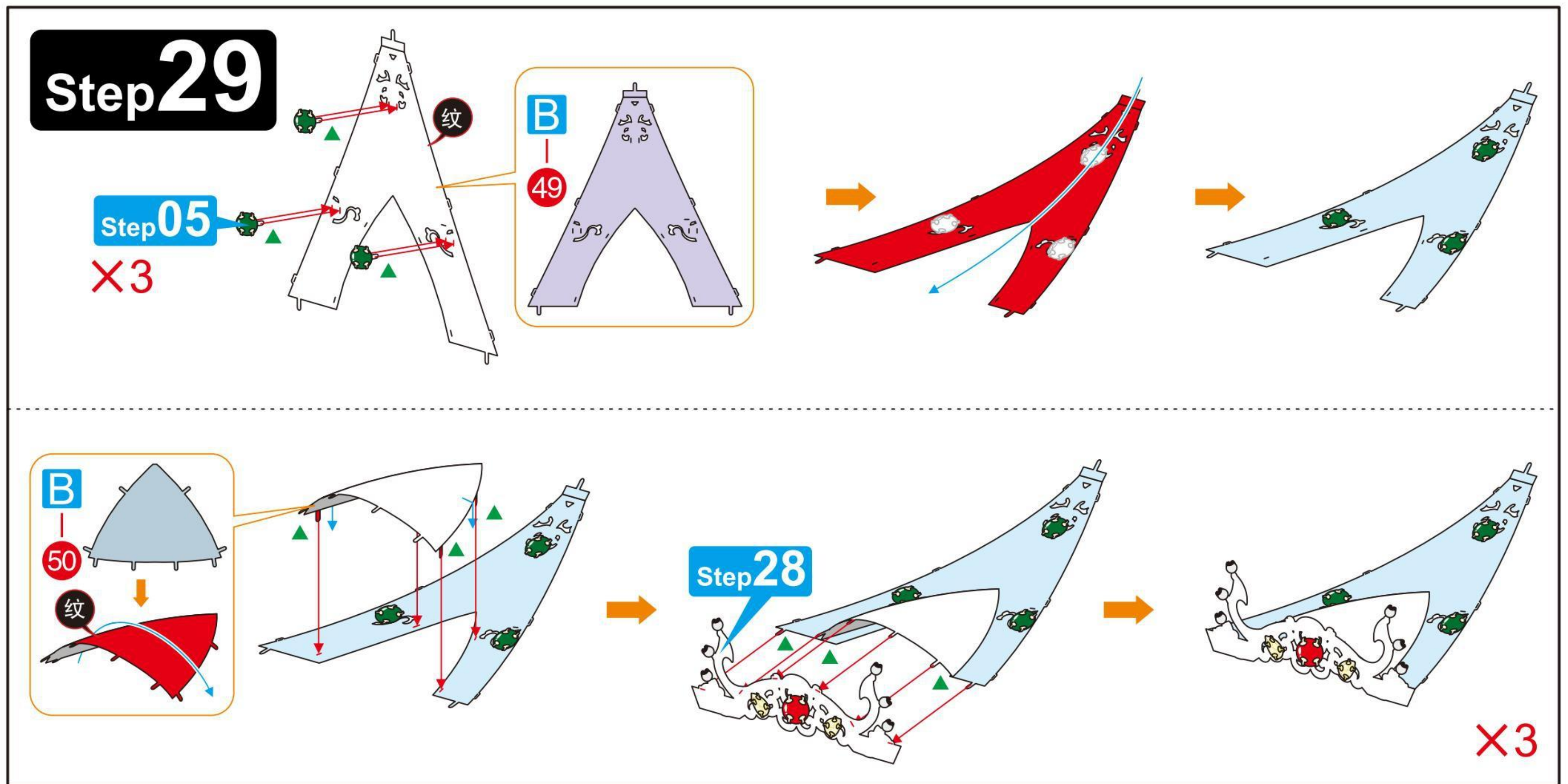
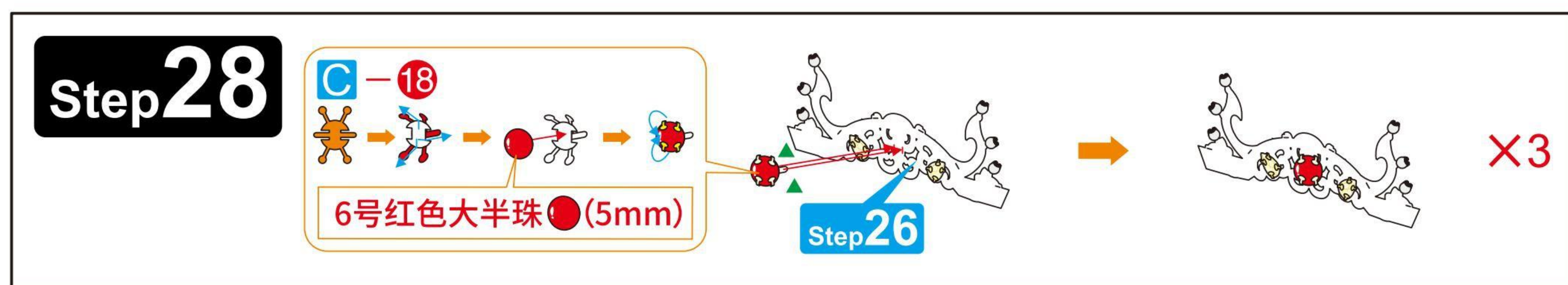
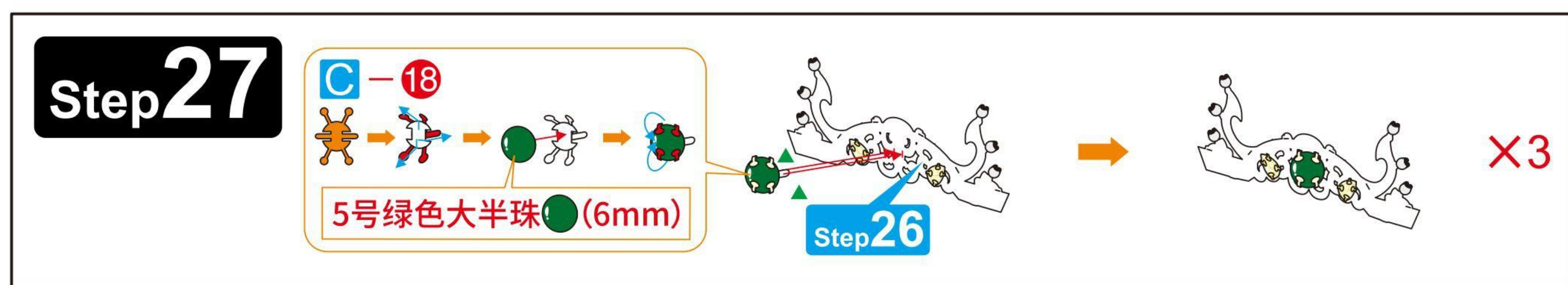
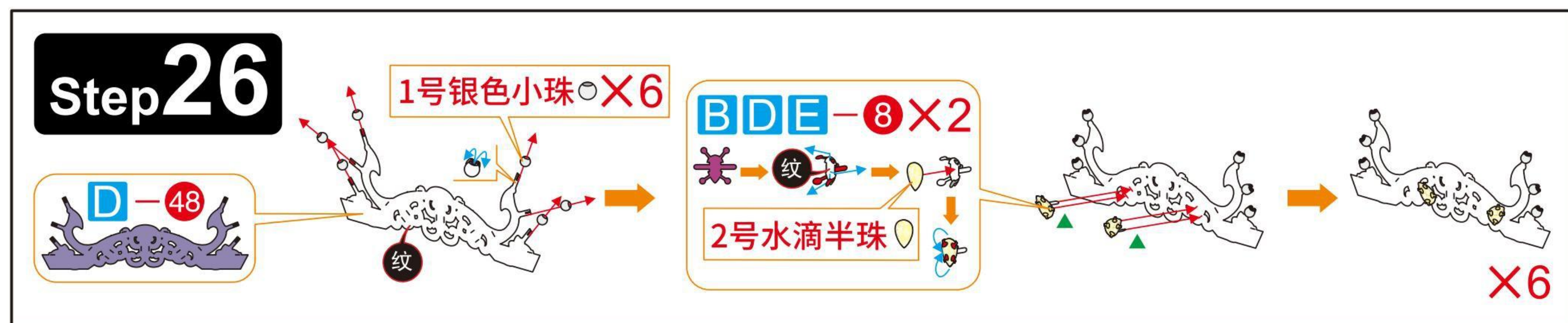
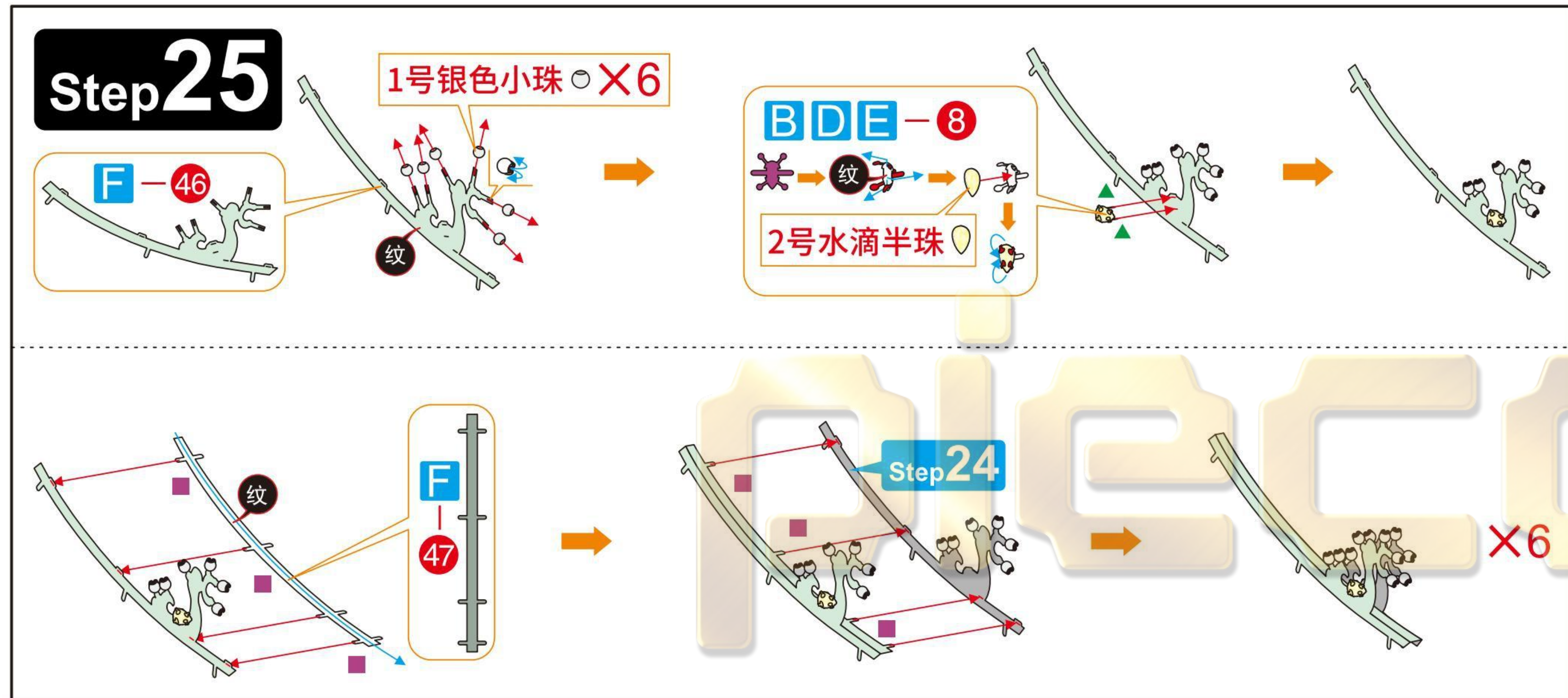
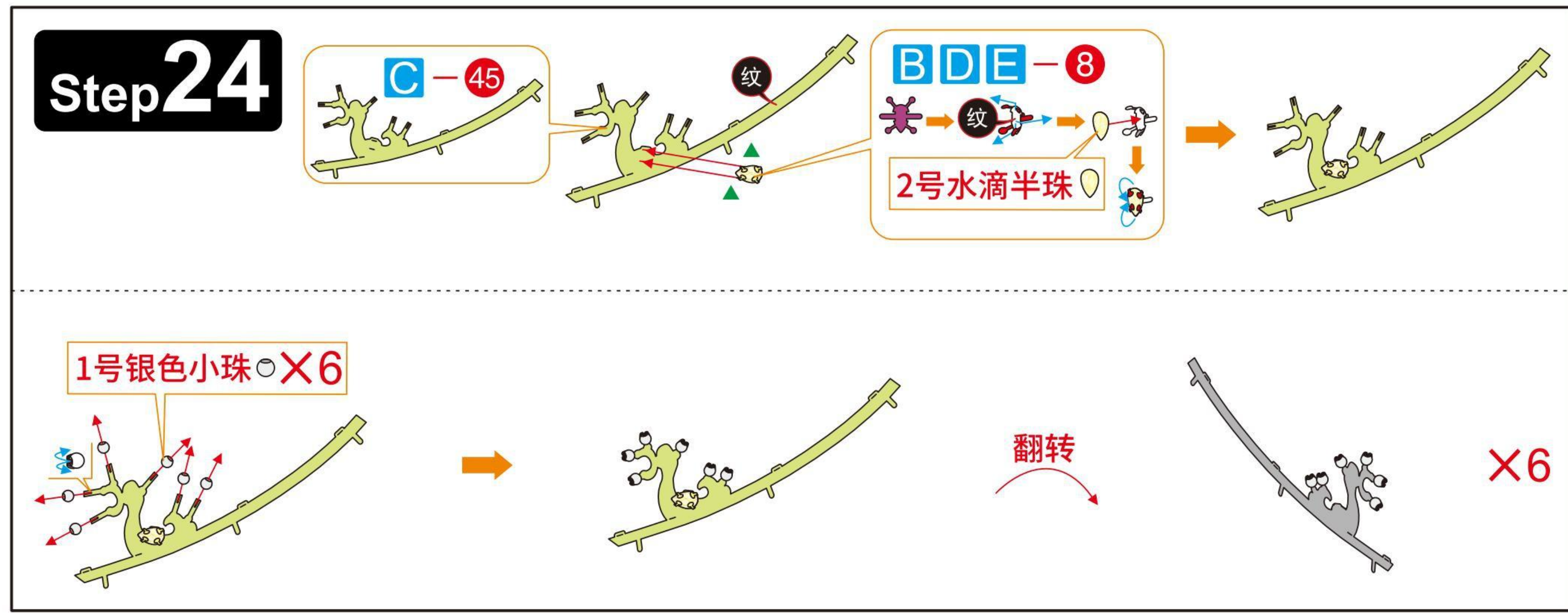

Step 33

注意先不闭合

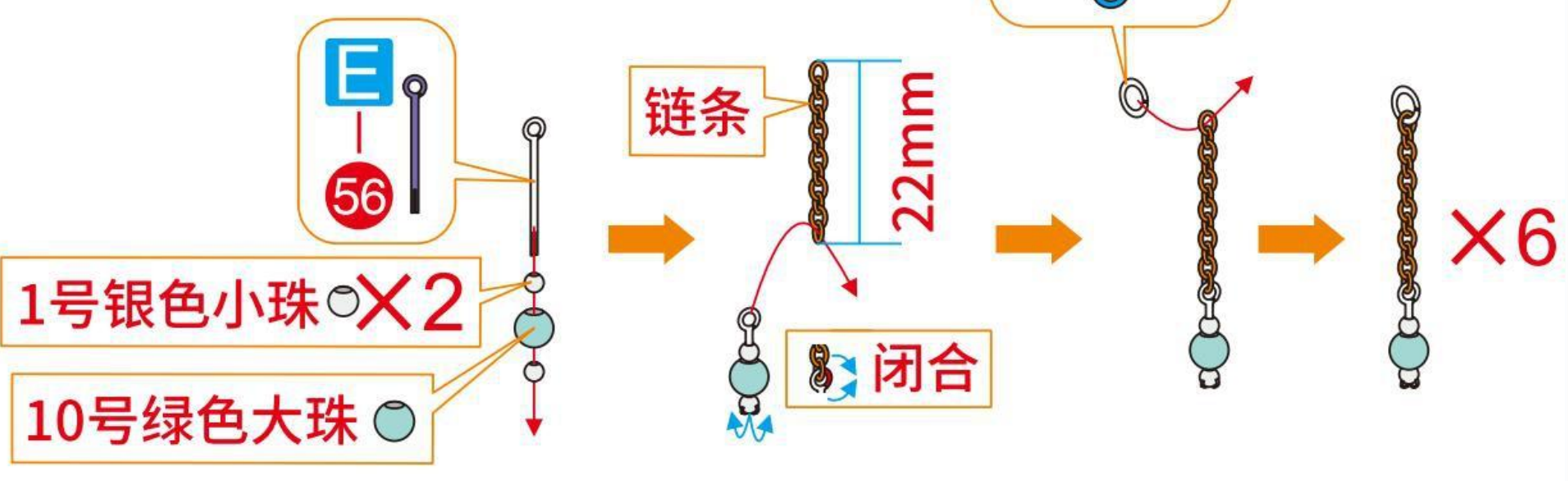

Step 34

1号银色小珠 $\times 2$
10号绿色大珠

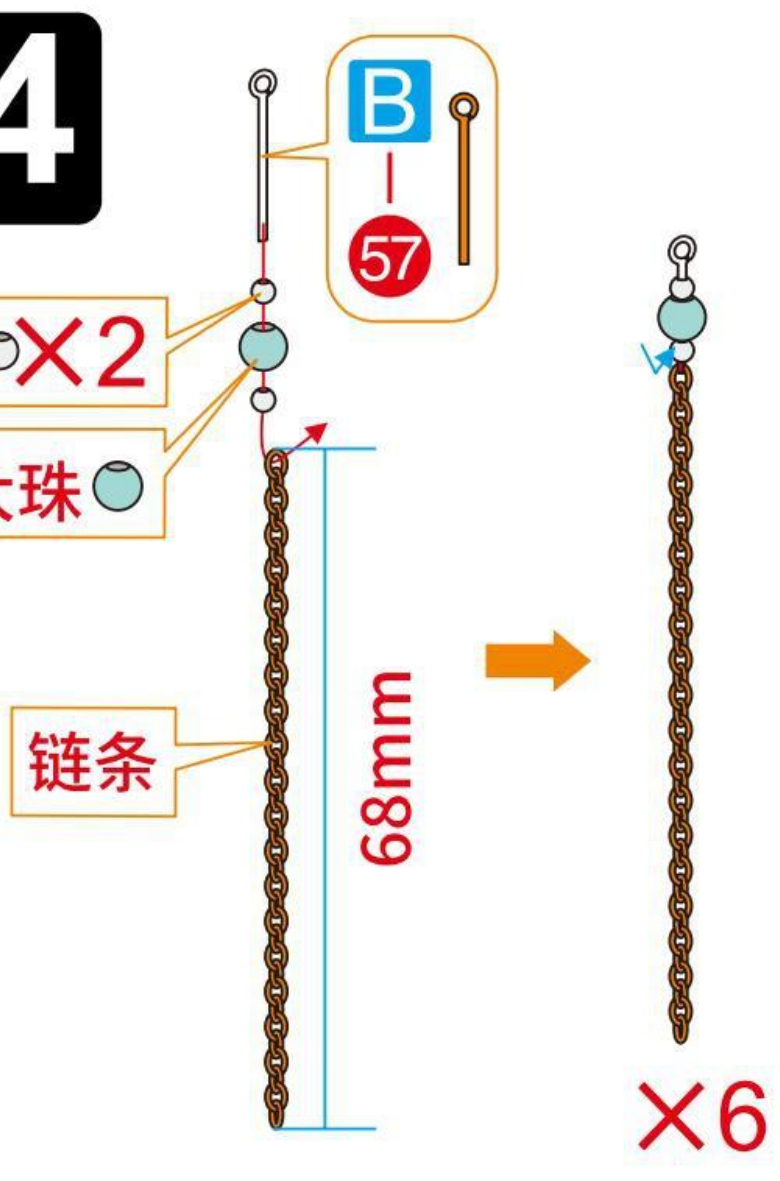

Step 35

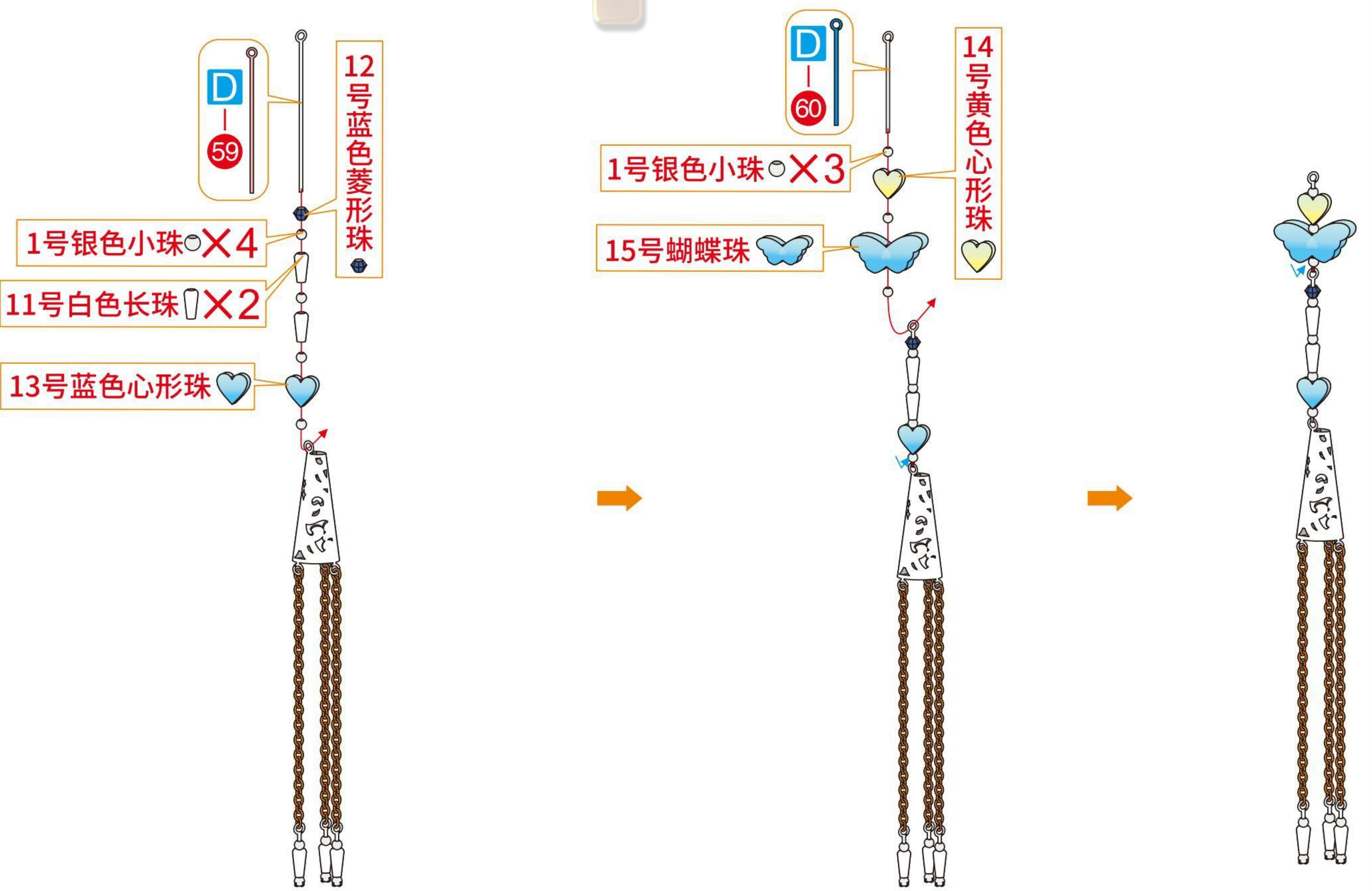
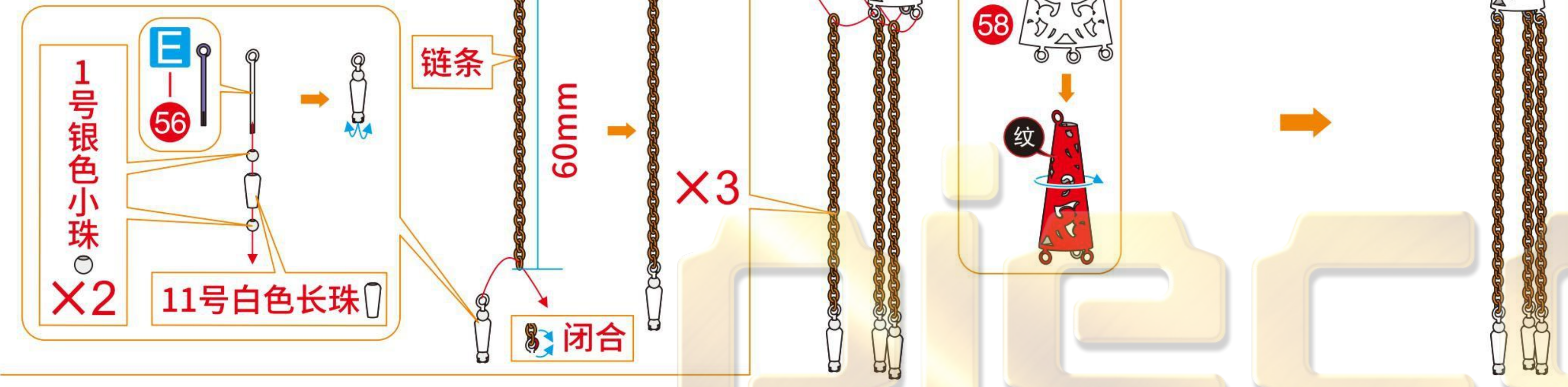

Step 36



13 14
15 16

