

山东舰
CNS SHANDONG
P267

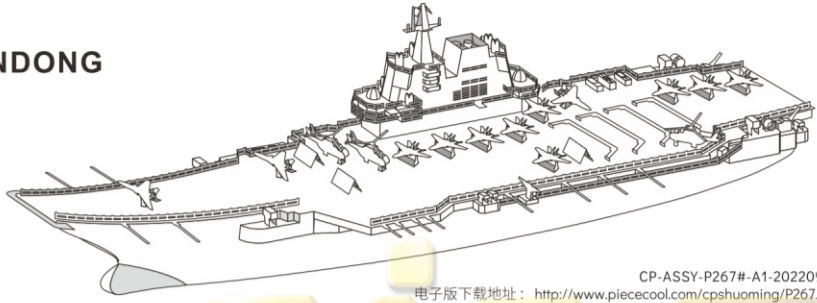

CP-ASSY-P267#-A1-20220927
电子版下载地址: <http://www.piececool.com/cpsuoming/P267.pdf>

拼前需知

⚠️ 组装时请小心处理金属零件，以防划伤

• 准备工具:

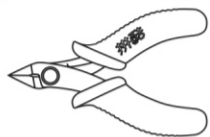

水口钳工具

修剪金属片板上的零件水口位。



尖嘴钳工具

弯折金属零件上的折叠线和扣点。

建议使用拼酷正品拼装工具（水口钳、尖嘴钳），拼装时更省心、省力，拼装后作品更精细、美观！

• 拼装方法:

a. 取下零件:



零件水口位
Nozzle Position
使用水口钳剪断金属零件上的水口，将需要的金属零件从金属片板上取下

b. 识别零件:

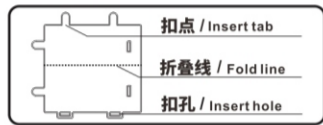

扣点 / Insert tab
折叠线 / Fold line
扣孔 / Insert hole
识别金属零件上的扣点，折叠线，扣孔的样子

c. 折叠零件:

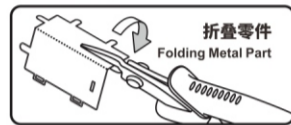

折叠零件
Folding Metal Part
使用尖嘴钳，参照拼装说明书将金属零件折成形状

d. 固定零件:



1 平折扣点
Bending Tab
● 插入扣孔,平折90°



2 弯折扣点
Twisting Tab
▲ 插入扣孔,旋转90°

• 注意事项:



剪金属零件时请剪零件“水口位”，请勿将“扣点”当成“水口位”剪下，每次剪零件时请仅剪当前步骤的零件，切勿一次性将所有零件全部剪下，避免丢失；
当遇到折叠线的零件，请注意金属片的正反面及拼折方向，请按照说明书的方向，轻剪慢折，最好一次性折叠完成，请勿反复折叠，避免零件损坏。

© Dongguan Weishi Culture Technology Co.,Ltd. All rights reserved.

拼装步骤

Step01

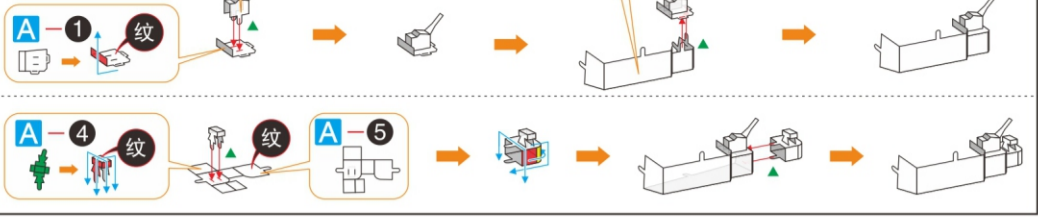

Step02

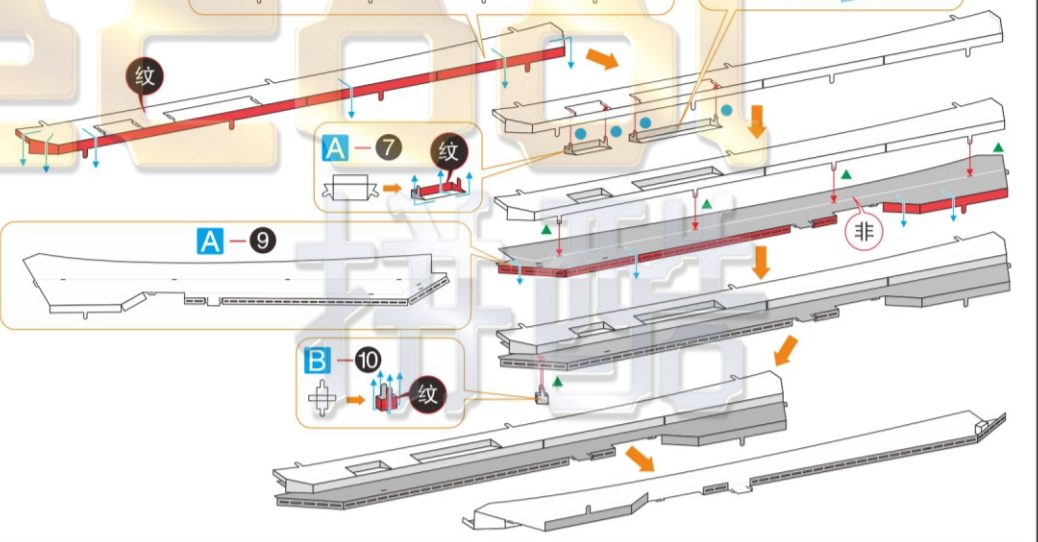

Step03



Step04

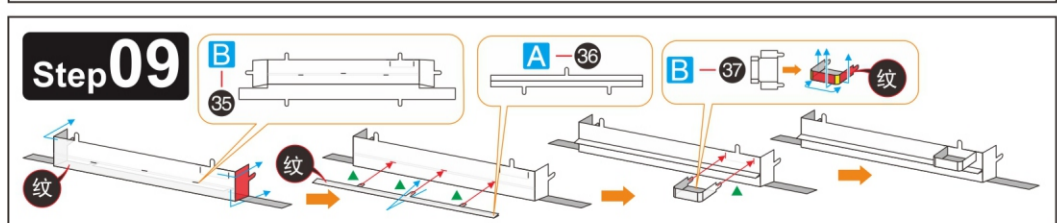
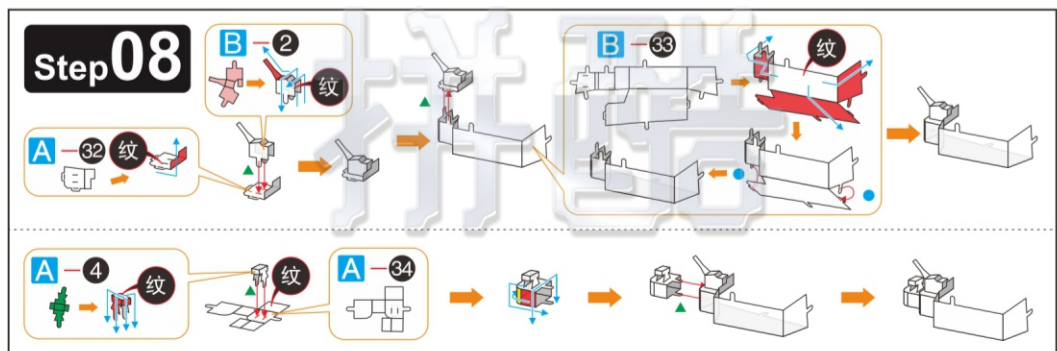
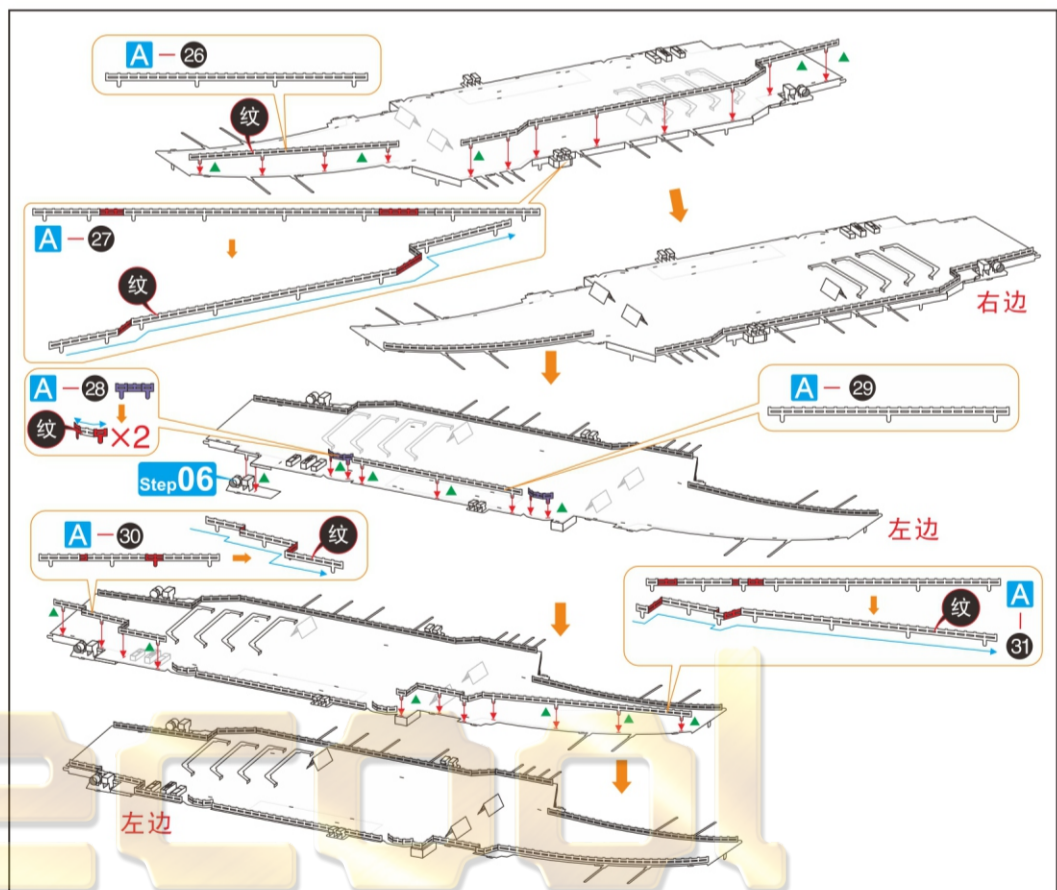
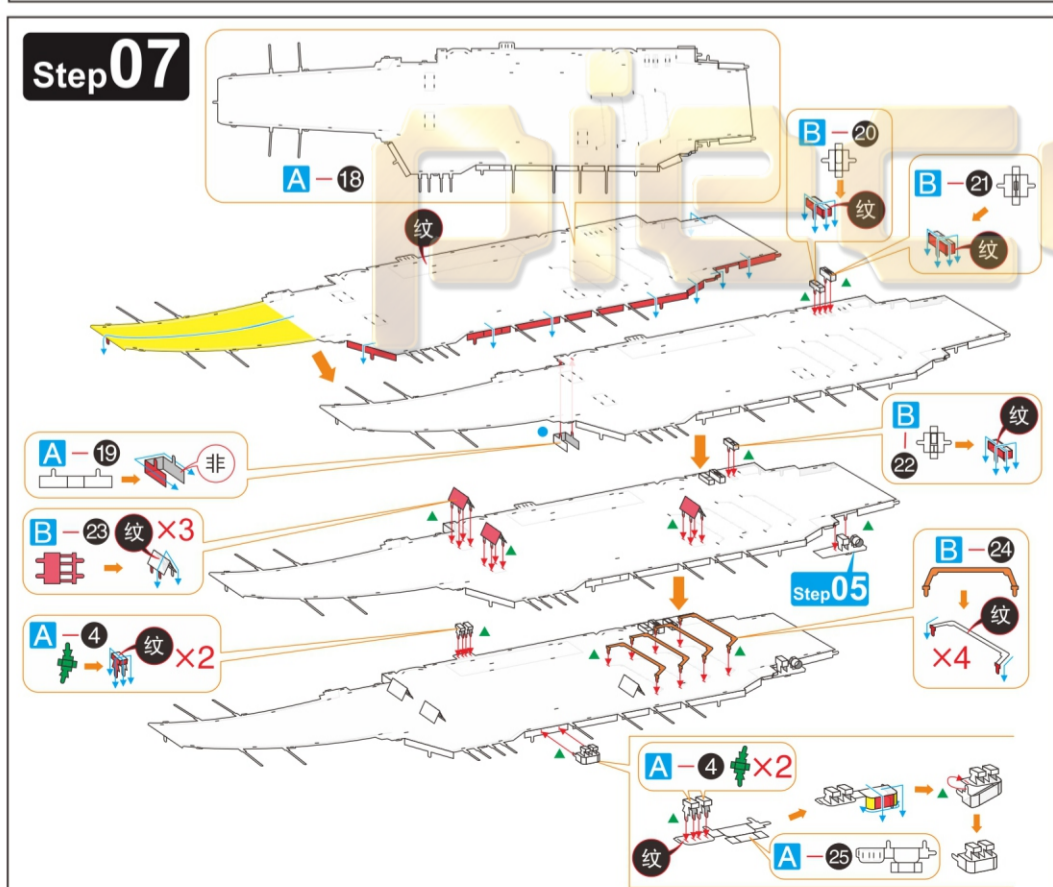
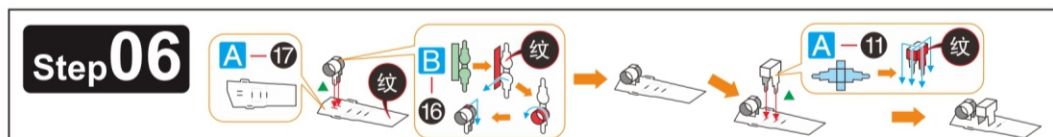
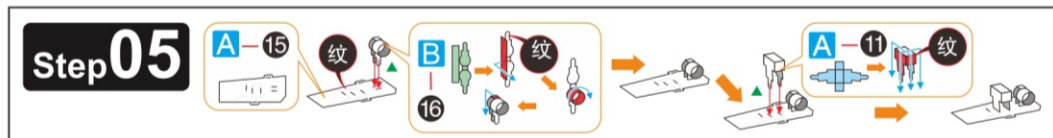
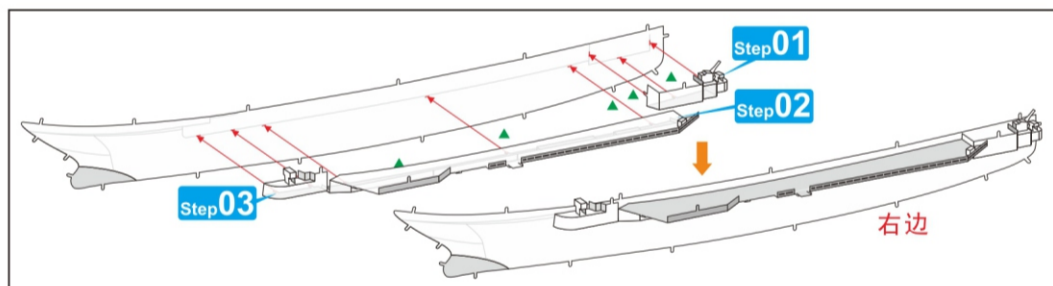
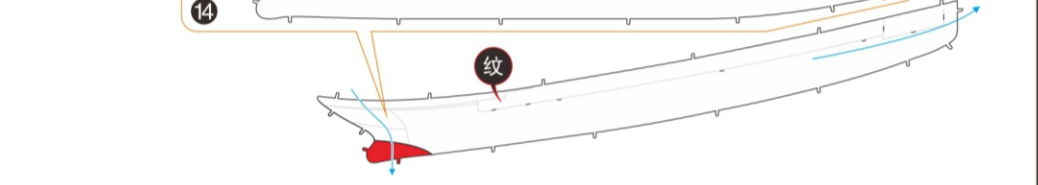

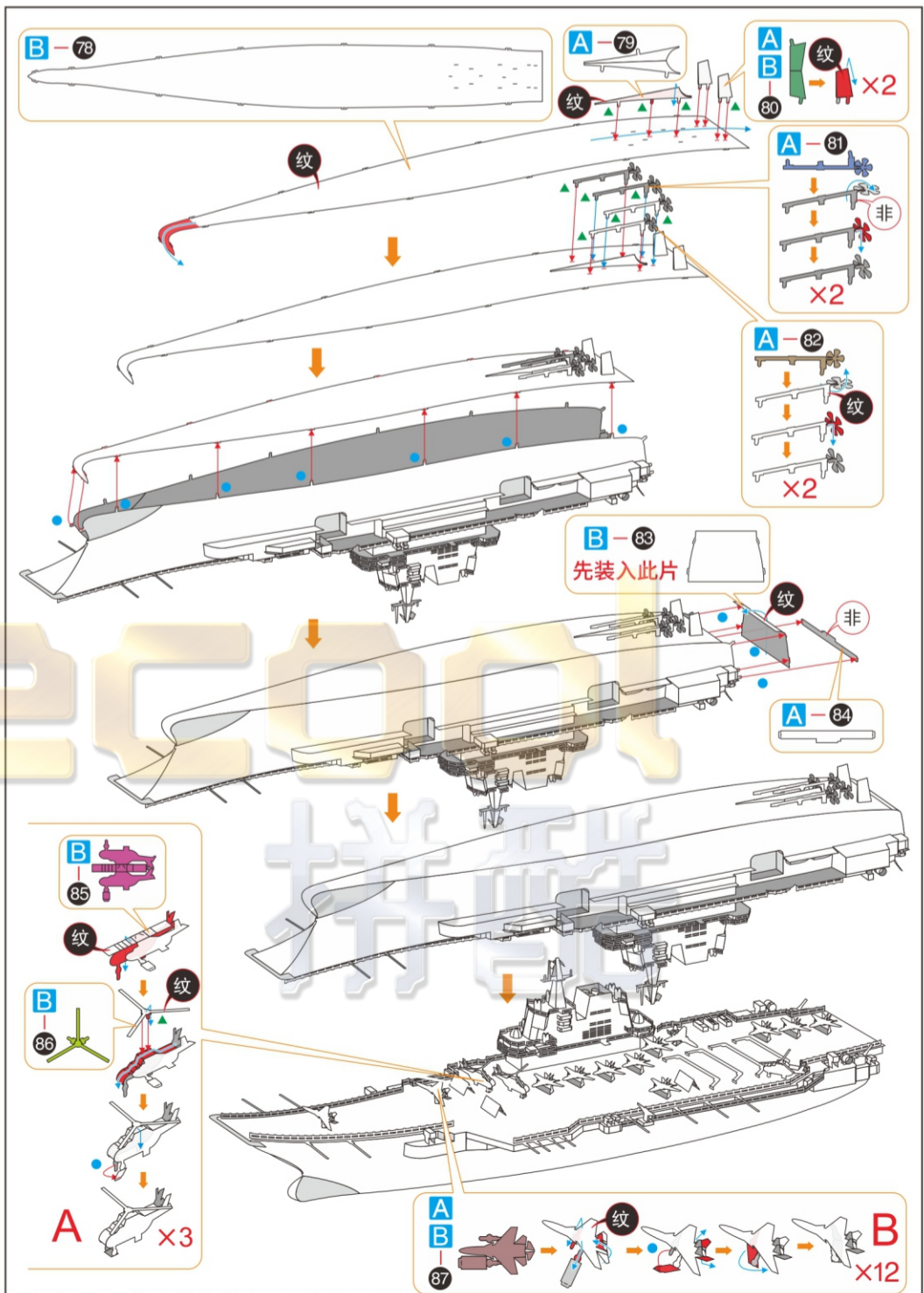
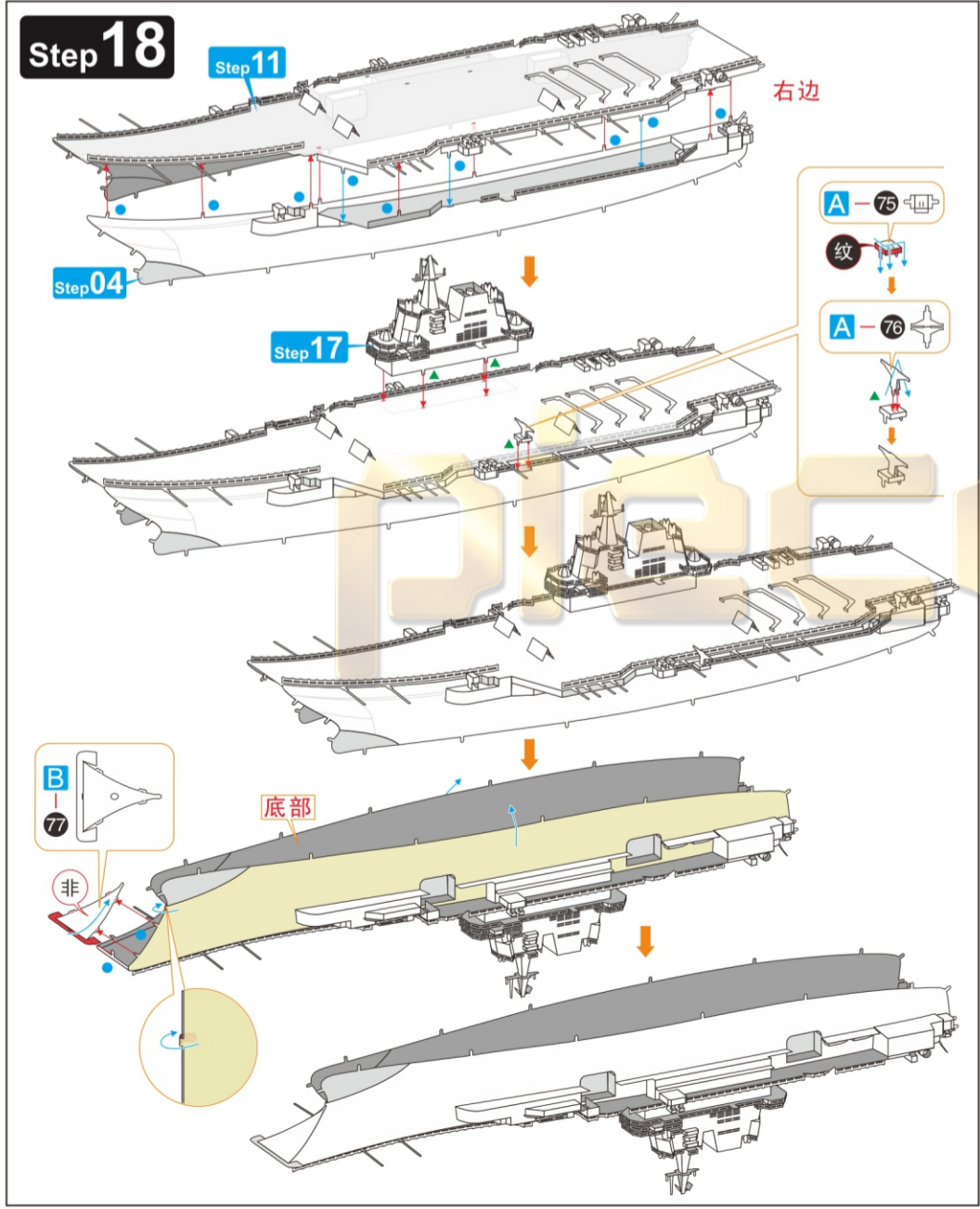
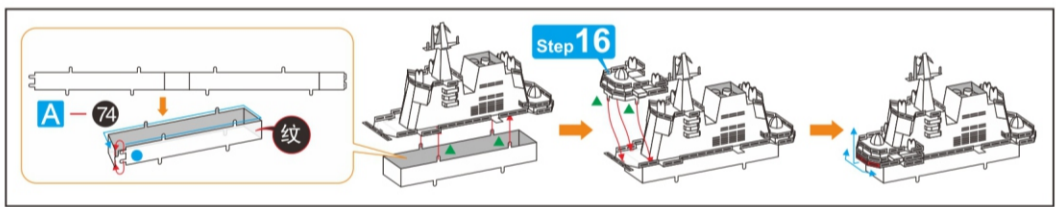
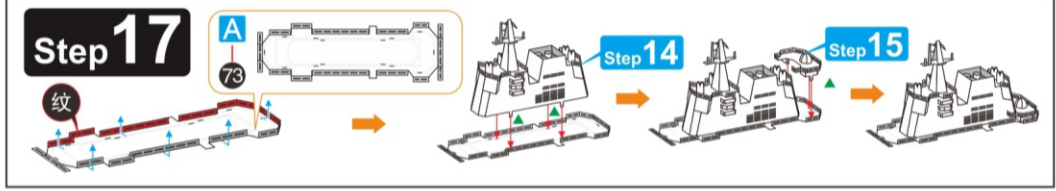
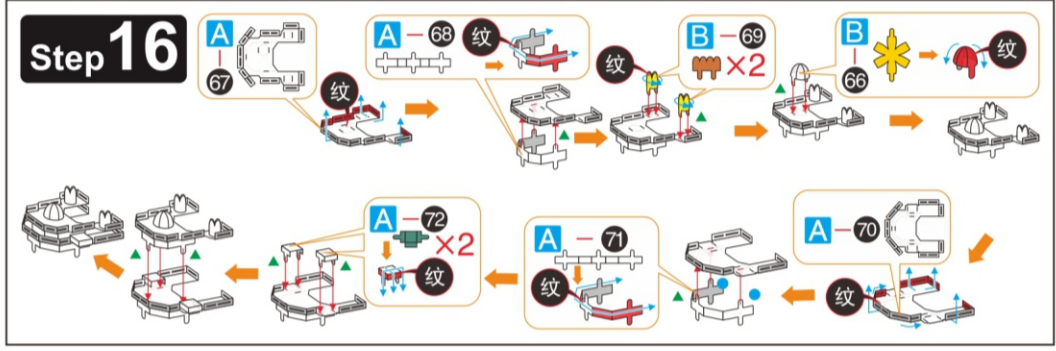
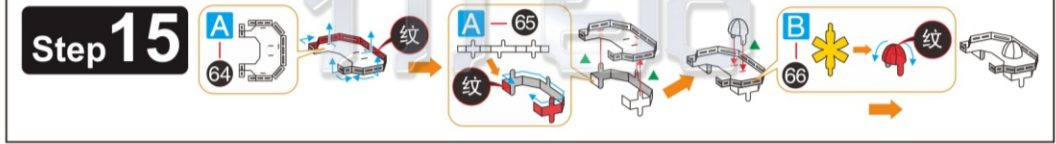
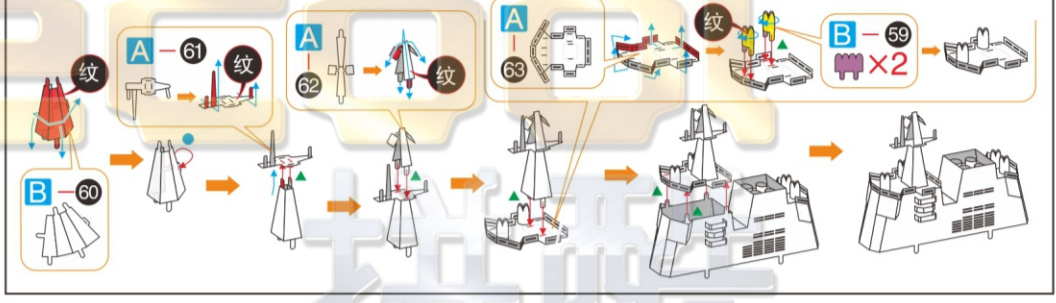
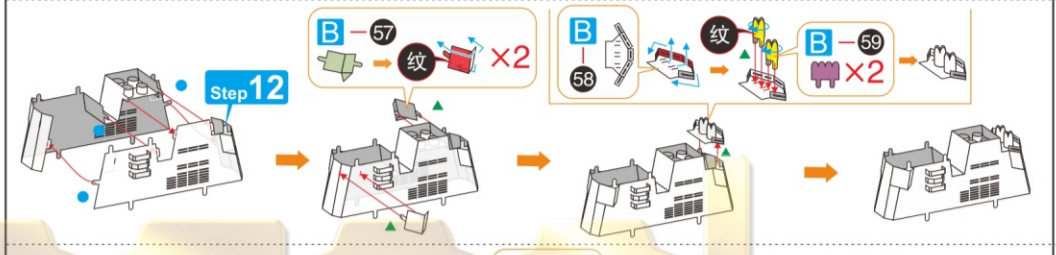
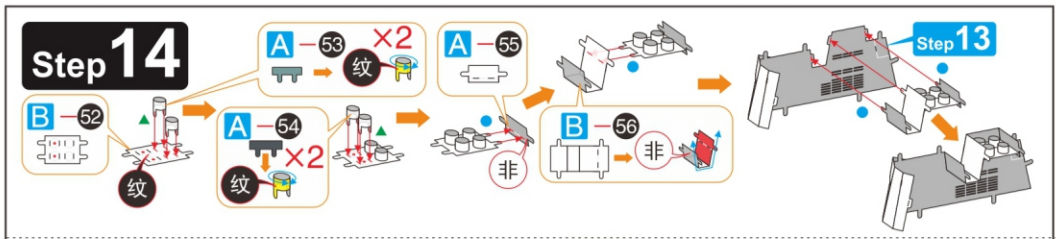
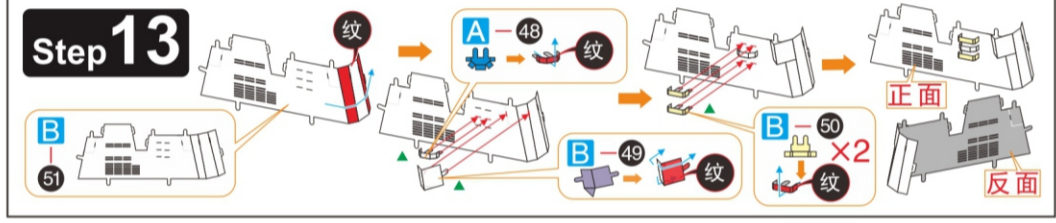
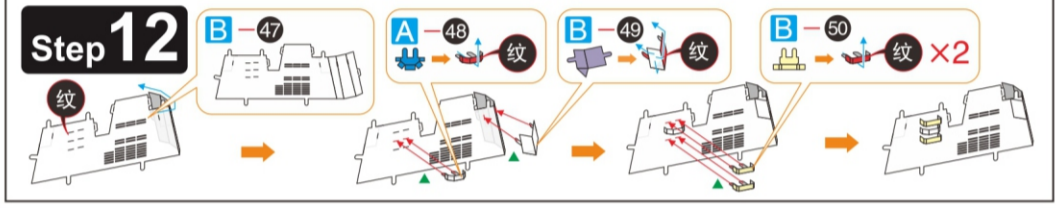
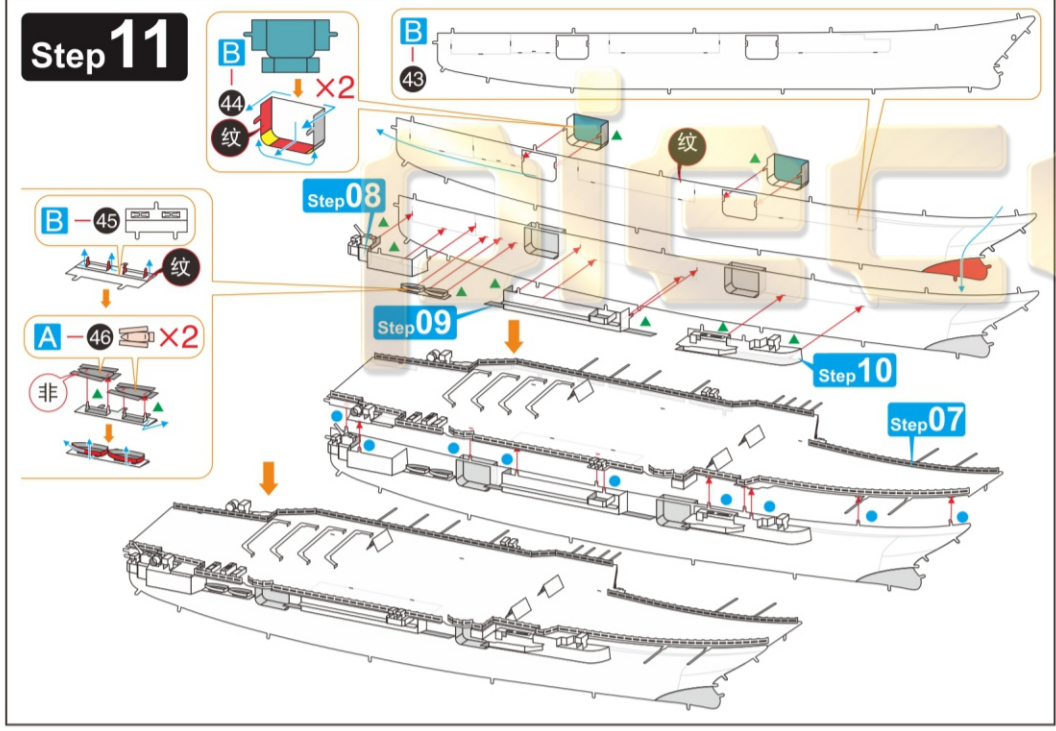
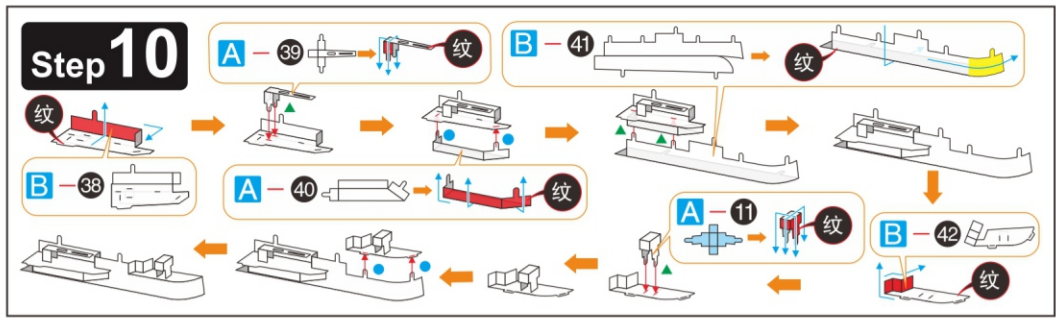

※A形状和B形状飞机可按个人喜好选择摆放 (※A-shaped and B-shaped aircraft can be placed according to personal preference)